

# M/Y BARON TRENCK

43.50 m, 478 GT







# BARON TRENCK



43.50 M / 142'09"

## THE EXPERT'S VIEW

*"BARON TRENCK was built by Eurocraft with an ice-breaker hull to explore the world, she is the largest yacht built by Eurocraft so far.*

*BARON TRENCK is incredibly stable at anchor, and she is even equipped by stabilizers zero speed. This explorer yacht is tailor-made for adventures across the high seas; from the tropics to the poles, where all you need to do is kick-back, relax and enjoy the spectacular vistas as you cruise on by. BARON TRENCK is in the top 30% by LOA in the world. She is one of 546 motor yachts in the 40-45m size range, and, compared to similarly sized motor yachts, her volume is 109.46 GT above the average."*

## SPECIFICATIONS

BUILDER	EUROCRAFT
BUILT / REFIT	2011 / 2023
BEAM (M/FT)	8.20 M / 26'11"
DRAFT (M/FT)	3.00 M / 9'10"
HULL MATERIAL	STEEL
GROSS TONNAGE	478
ENGINES	2 x MTU TYPE 12V 2000 M60
SPEED	10 KNOTS / 13.5 MAX
CLASS	COMMERCIAL UNRESTRICTED
FLAG	PORTUGAL
EXTERIOR DESIGNER	EUROCRAFT STUDIO
INTERIOR DESIGNER	EUROCRAFT STUDIO
GUEST / STATEROOMS	12 / 6
CREW	9



# BARON TRENCK





# BARON TRENCK





# BARON TRENCK





# BARON TRENCK





# BARON TRENCK





# BARON TRENCK





# BARON TRENCK





# BARON TRENCK





# BARON TRENCK

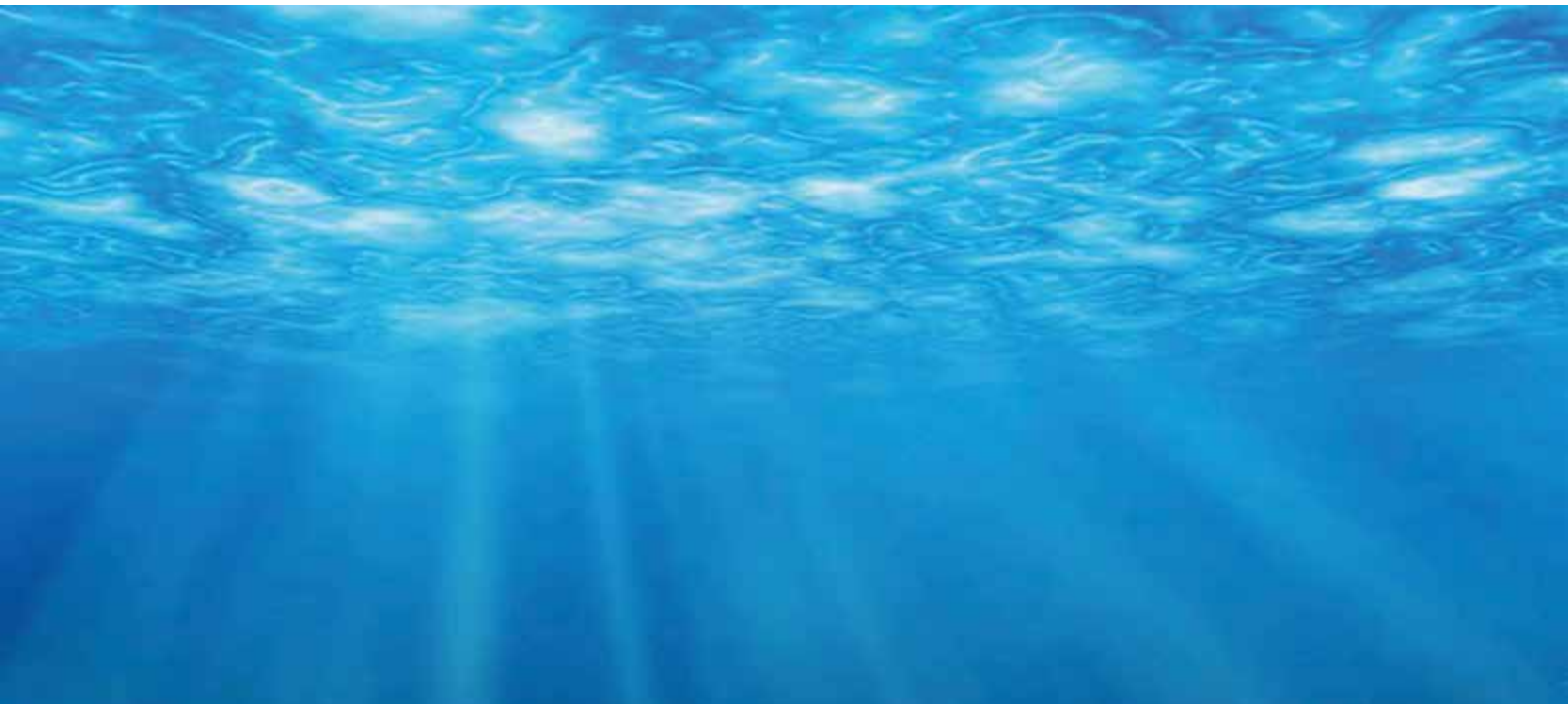



# BARON TRENCK





# BARON TRENCK





# BARON TRENCK





# BARON TRENCK





# BARON TRENCK

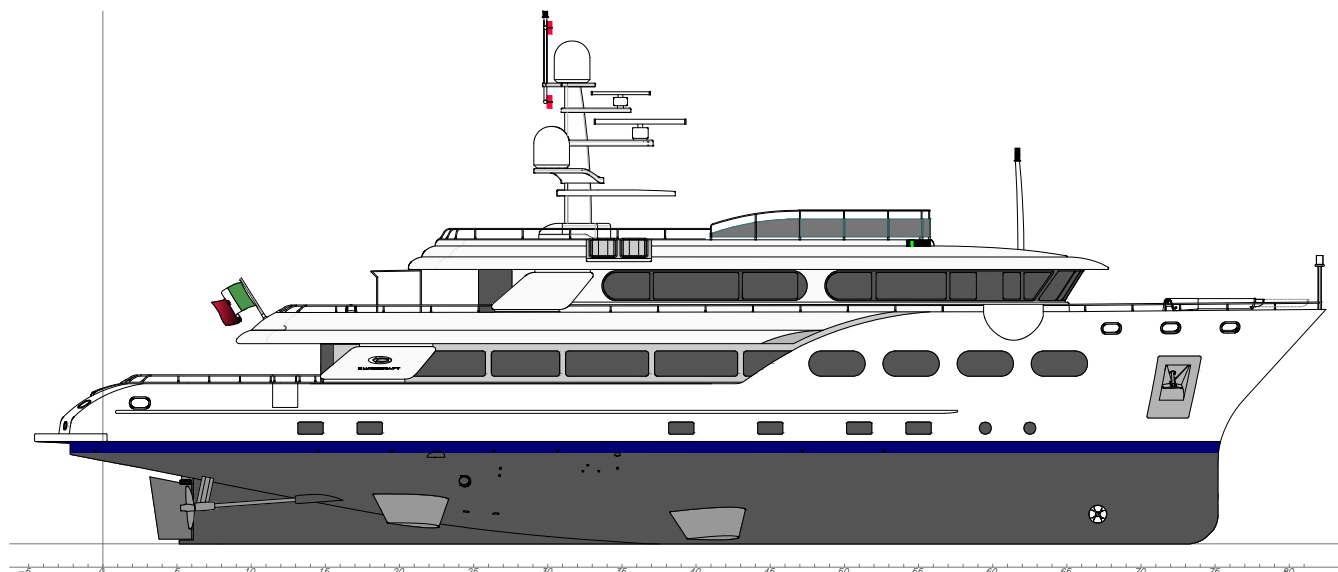

PONTE SOLE

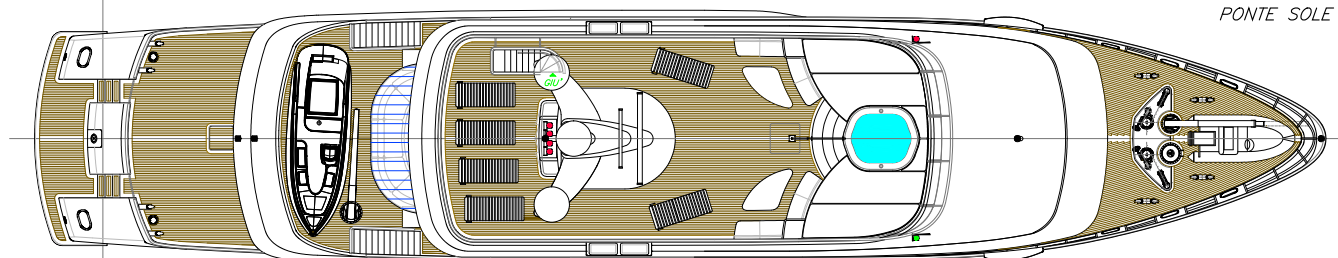

PONTE TIMONERIA

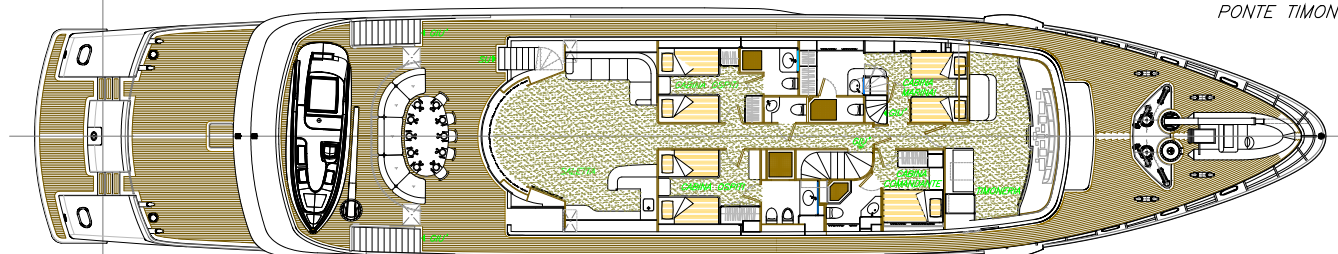

PONTE COPERTA

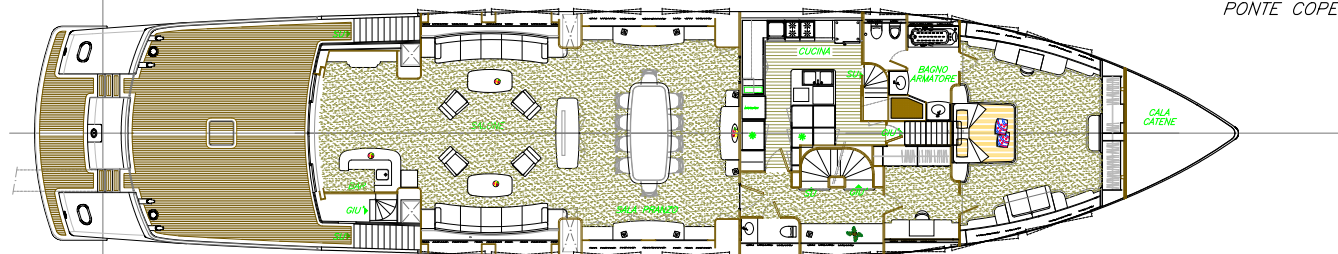

PONTE INFERIORE

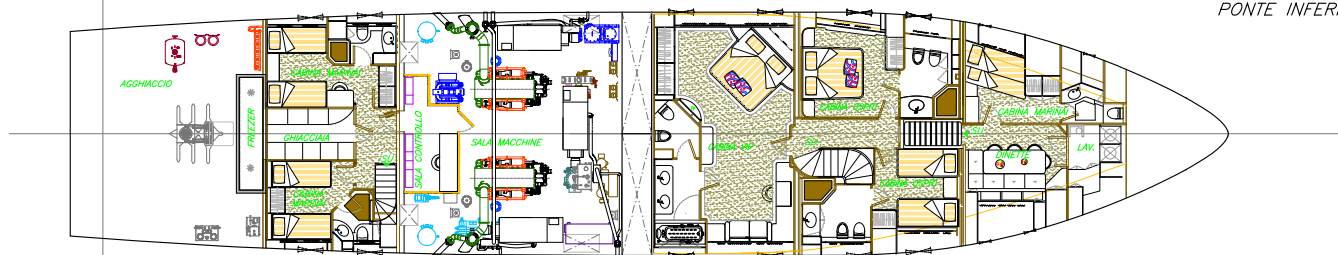



# BARON TRENCK



## MAIN CHARACTERISTICS

Name:	BARON TRENCK	
Type:	Motor yacht	
Builder:	Eurocraft	
Year:	2011	
Refit Year:	2023	
Hull No:	00507	
Yacht Model:	Explorer	
LOA (M/FT):	43.50 M	142'09"
LWL (M/FT)	38.17 M	125'03"
Beam overall (M/FT):	8.20 M	26'11"
Draft (Full Load) (M/FT):	3.00 M	09'10"
Gross Tonnage:	478	
Displacement:	425 T	
Hull Material:	Steel	
Hull Configuration:	Mono	
Superstructure:	Aluminum	
Decks:	4	
Flag:	Portugal	
Classification:	Commercial Vessel – Unrestricted Navigation	
Exterior Designer:	Eurocraft Studio	
Interior Designer:	Eurocraft Studio	
Main Engines:	2 x Diesel Engines MTU Type 12v 2000 M60	
Max Speed:	13.5 knots	
Cruising Speed:	10 knots	
Range:	11,660 nm @ 10 knots	
Guest Accommodations:	12 guests in 6 staterooms	
Crew Accommodations:	9	
Minimum Safe Manning:	5	



# BARON TRENCK



## CLASSIFICATION

Flag:	Portugal
Port of Registry:	Funchal - Madeira
Classification:	Member Of IACS
IACS Society:	Bureau Veritas
Additional Class Information:	Commercial Vessel – Unrestricted Navigation
EU Tax Status:	Not Paid
US Tax Status:	Not Paid
IMO Number:	009636993
MMSI Number:	255804670
Official Registration:	MAR 1412
Home Port:	Loano (I)

## REGULATION

Vessel Registration:	Commercial
Built to Commercial Compliance:	Rina Charter Class
MARPOL Code:	Yes

## SQUARE METERS

TOTAL INTERIOR	281 m <sup>2</sup>	3,025 ft <sup>2</sup>
SUN DECK Spa	107 m <sup>2</sup>	1,152 ft <sup>2</sup>
BRIDGE DECK	59 m <sup>2</sup>	635 ft <sup>2</sup>
Upper Saloon	27 m <sup>2</sup>	291 ft <sup>2</sup>
Lobby and day toilet	8 m <sup>2</sup>	86 ft <sup>2</sup>
Guest cabins	24 m <sup>2</sup>	258 ft <sup>2</sup>
MAIN DECK	148 m <sup>2</sup>	1,593 ft <sup>2</sup>
Main Saloon	90 m <sup>2</sup>	969 ft <sup>2</sup>
Lobby and day toilet	10 m <sup>2</sup>	108 ft <sup>2</sup>
Owner's Cabin	48 m <sup>2</sup>	517 ft <sup>2</sup>
LOWER DECK	67,5 m <sup>2</sup>	727 ft <sup>2</sup>
VIP Cabin	35 m <sup>2</sup>	377 ft <sup>2</sup>
Double Cabin	16 m <sup>2</sup>	172 ft <sup>2</sup>
Twin Cabin	13 m <sup>2</sup>	140 ft <sup>2</sup>
Lobby	3,5 m <sup>2</sup>	38 ft <sup>2</sup>



# BARON TRENCK



## ACCOMMODATIONS

### OVERVIEW:

A three-deck yacht with large aft external decks and a big sun deck, two dining areas; one inside on the main deck and one alfresco on the aft bridge deck, the main saloon on the main deck and a sky lounge on the bridge deck.

### ACCOMMODATIONS:

There are 6 guest staterooms to host up to 12 guests, including a VIP stateroom and the owner stateroom.

### LOWER DECK:

At lower deck there are three guest staterooms, a twin, a double and a VIP built with fine materials, all bathrooms have marble finishing. In the full width VIP stateroom, there is a sofa, a vanity and a bathroom with Jacuzzi and separate toilet.

### MAIN DECK:

The main saloon connected with the main dining make an ample space with two sofas, a bar, TV and entertainment.

### OWNER'S STATEROOM:

A studio separates the main lobby from the full width owner stateroom. In the bright stateroom with four windows there is a sofa and a vanity. The marble finished bathroom is equipped with Jacuzzi, shower, and separate toilet.

### BRIDGE DECK:

There are two twin guest staterooms and a lounge with bar, TV and entertainment. Outside on the aft there is a dining area.

### SUN DECK:

The sun deck is a wide space for sunbathing equipped with a Jacuzzi pool, a shower and a bar.

## CONSTRUCTION

Hull Material:	Steel
Superstructure Material:	Aluminum
Deck Material:	Teak
Paint:	Awlgrip
Number of Decks:	4

## CAPACITIES

Tonnage:	Gross Tons	478
	Net Tons	143
	Displacement tons	425
Fuel Capacity:	105,000 Litres	27,738 US Gallons
Fresh Water Capacity:	23,270 Litres	6,147 US Gallons
Water Makers:	160 Litres	42 US Gallon
Grey and Black Water:	4,270 Litres	1,128 US Gallon

	Speed	Consumption l/h	Range	RPM
Maximum	13.5	250	5,670	1,700
Cruising	10	90	11,660	1,150
Economical	6	25	25,000	600



# BARON TRENCK



## MAIN MACHINERY

Main Engines:	2 x MTU Type 12V 2000 M60, 600 kW
Engine Hours (December 2022):	Port: 6,542 Hours - After W6 480 Hours Starboard: 6,539 Hours - After W6 480 Hours
Propulsion Type:	Propeller Shafts
Engine Controls:	Electronic
Engine Mounts:	Vulkan
Engines exhaust system:	Underwater
Gear Boxes:	ZF 2550
Shafting:	Conventional Shaft Line
Propellers:	Detra 5 Blades
Engine Ventilation:	2 x Gianneschi EL3630, Natural and Forced

## GENERATORS & ELECTRICITY

Output/Electricity:	400 V – 50 Hz
Generators:	3 x ONAN 80 kW 400 VAC, 3 phase, 50 Hz
Generator Hours (December 2021):	Port: 8,066 Hours - After revision 731 Hours Centre: 8,060 Hours - After revision 714 Hours Starboard: 7,963 Hours - After revision 621 Hours
Generator Fuel Consumption:	10 L/H
Generator Exhaust System:	Side Hull
Shore Power:	Yes
Shore Power Transformer:	Frequency Converter: 320/520Vac-3ph-40/70Hz > 400Vac-3ph+N-50Hz 100KVA
Batteries:	24 V
Generator Start:	Automatic
UPS (uninterruptible power supplies):	0 Passage

## AUXILIARY MACHINERY

Steering System:	Hand steering normal operation from wheelhouse or wings and hand steering in emergency in the control room, automatic pilot to be settled on wheelhouse
Bow Thruster:	NAIAD MARINE VT 75 – 83 kW
Stabilizers:	Yes, Speed 0, Type Four hydraulic NAIAD MARINE Model 525 0 speed
Helm/Wing Station Controls:	Yes

## Fuel & Oil System

Fuel Filters:	Duplex Racor Filters
Fuel Oil Separator:	CJC PTU 1 27/54
Fuel Transfer Pump:	Trilub 140R46U8 6-V-W115
Fuel Filling Pump:	Yes
Oily Bilge Water Separator:	Yes
Dirty Oil Pump:	Yes

## Firefighting & Bilge System

Firefighting & Bilge Pump:	Yes
----------------------------	-----



# BARON TRENCCK



## Fresh Water System

Fresh Water Makers:	1 x Seafresh H206A.F + 1 x HP 440lt/h orizzontale on RPTRONIC
Fresh Water Treatment:	Yes
Fresh Water Pressure:	2 x Calpeda B NG 6/22/A 230/400 V 3F 50 Hz 1,5 Kw
Hot & Cold Circulation Pump:	Gianneschi Z40 230/400 V 3F 50 Hz
Hot Water Boilers:	2 x Gianneschi

## Black & Grey Water System

Black & Grey Water Treatment:	Triton
WC's (toilets/bidets):	Yes
Sanitary Vacuum System:	EVAC
Grey Water Discharge Pumps:	Yes

## AC & Ventilation System

Air Conditioning:	FRIGIT
Air Compressor:	Yes, manufactured by Mattei, ERC 5H 400-3 X
Provision Refrigeration:	Yes
Engine Room Ventilation:	2 x exhaust Gianneschi EL630 fans

## Hydraulic System

Hydraulic Power Packs:	Yes
------------------------	-----

## NAVIGATION & COMMUNICATION SYSTEMS

### NAVIGATION SYSTEMS

Navigation Bridge:	Yes
Monitors:	x 5
X-Band Radar:	FURUNO, 2117
S-Band Radar:	FURUNO, 2137
Multifunctional Workstation:	Yes
Chart Plotter:	Transas
UPS:	Yes
Magnetic Compass:	C. Plath Juppjter
Gyrocompass:	Wheel Mark SIMRAD RG 85
Auto Pilot:	Wheel Mark SIMRAD AP-50
Rudder Angle Indicator System:	Yes
Echo Sounder:	2 x FURUNO FE 700
Speed Log:	FURUNO
DGPS:	Yes
GPS:	FURUNO GPS Sensor mod. GD 150
AIS:	FURUNO AIS FA 150
Navtex:	FURUNO NX-700
Wind Instruments:	FURUNO Wind Sonic
Horn:	Yes
Search Lights:	Yes, 220W - 230V
Bridge Navigation Watch Alarm:	Yes
Ships Computer:	Yes



# BARON TRENCK



## COMMUNICATION SYSTEMS

SAT com:	Yes
INMARSAT – C:	2 x FURUNO FELCOM 15
ECDIS:	Transas
VHF Radiotelephones:	FURUNO & SIMRAD
Portable VHF:	FURUNO
Portable GMDSS VHF:	2 x Sailor Handheld
Iridium Satellite Phone:	Yes
Intercom – Talk Back:	Yes
Telephone System:	Panasonic
Intercom System:	Zenitel
VHF Digital Radios:	Yes
SSB:	FURUNO SSB MF/HF
EPRIB:	Yes
Radar Transponders:	FURUNO
Navtex Receiver:	FURUNO NX-700
GMDSS Battery Plant:	260 VA 24 Vcc GMDSS Battery Set
Guest Phones:	Yes
Internal Ship's Communication:	Yes

## DECK MACHINERY & EQUIPMENT

anchors:	x 2, 240kg HV Type
	1 x Emergency
Anchor Chains:	350 M
Anchor Windlass System:	2 x Electric Vertical, Data / Hydro Systems DZC 3300 11 kW
Cranes:	1 x Mor C-079 Tel, Capacity 1,200 Kg
	1 x Mor C-0778 Tel Rb, Capacity 600 Kg
Warping Capstans:	2 x Data / Hydro Systems 7.5 kW
Bow crane:	Yes
Passerelle:	Mor
Side Boarding Ladder:	Yes
Sea-stair:	Yes
Stern Boarding Gangway:	Yes
Swimming Ladder:	Yes
Spotlights:	Yes
Paint Exterior:	AWLGRIP
Paint Interior:	Yes
Paint Underwater:	BOERO



# BARON TRENCK



## SAFETY, SECURITY, & FIRE FIGHTING EQUIPMENT

Security System:	
CCTV:	Panasonic
Cameras:	Panasonic
Monitors:	Panasonic
Ship's Safe:	Yes
Doorbell:	Yes
Fixed Firefighting System:	Yes
Firefighting Equipment:	Yes
Gas Detection:	Yes
Fire Alarm:	Yes
Alarms:	Yes
MOB boat:	Yes
Life rafts:	4X12 people life rafts
Breathing Apparatus:	x 2
Lifejackets:	Yes
Immersion suits:	Yes
Life Rings:	Yes
EPIRBs:	Yes
Flares:	Yes
Medical Equipment:	Yes

## ENTERTAINMENT, AUDIO/VISUAL AND IT SYSTEMS

Video Equipment:	Yes
TVRO:	Yes
VSAT:	TV System SEATEL 4006
Audio Equipment:	Each stateroom is equipped with TV and AV rack with amplifier, DVD player and TV decoder, 2 x speakers and sub-woofer Owner's Stateroom, main saloon and sky lounge have 5 x speakers and a sub-woofer
Control:	Yes
Main Salon:	TV, AV rack with amplifier, DVD player, tv decode, play station and Bluetooth connection
Master Stateroom:	SAMSUNG LED LCD TV, ONKIO TX SR 608, YAMAHA YST SW 310, B&W SPK, ONKIO BD SP 308 DVD BLURAY, TOPFIELT HSCI 7700, PHILIPS Pronto Remote control
VIP Stateroom:	SAMSUNG LED TV, ONKIO LSV 501 Amplifier, B&W SPK, TOPFIELT HSCI 7700, PHILIPS Pronto Remote control
Guest Staterooms:	SAMSUNG LED TV, ONKIO LSV 501 Amplifier, B&W SPK, TOPFIELT HSCI 7700, PHILIPS Pronto Remote control



# BARON TRENCK



Sky Lounge:	TV, AV rack with amplifier, DVD player, tv decode, play station and Bluetooth connection
Exterior, Aft Deck, Bar, Bridge Deck:	2 x Speakers at main aft deck, 2 x speakers at bridge aft deck 6 x speakers at sun bridge with additional amplifier
Captain's Cabin:	TV, decoder and car stereo
Crew Mess:	TV, DVD player, decoder and car stereo
Hybrid Digital PABX / VOIP:	Yes

## GALLEY & LAUNDRY EQUIPMENT

### MAIN GALLEY EQUIPMENT

Cooking Equipment:	2 x AMBACH Electric Induction Kitchen AMBACH Multifunctional Electric Braseria RATIONAL Oven INKSINK EVOLUTION10 Waste Disposal Panasonic Microwave CUPPONE Food Mixer
Refrigeration/Freezer:	FRIGIT / Blast chiller (Coldline)
Dishwasher:	MEIKO
Other:	Glass Washer CASTEL MAC Ice Maker Rolla Dump Waitor

### PANTRIES AND OTHERS

Refrigeration/Freezer:	Yes
Other:	Oven Rational SCC61E

### CREW GALLEY / MESS EQUIPMENT / COOKING EQUIPMENT

Sundeck:	Refrigeration - Grill
Wine Storage:	LIEBHERR
Main Laundry Equipment:	2 x Washing Machine Miele Professional PW 6065 Vario 2 x Dryers Miele Professional PT7136 Vario

## OTHER EQUIPMENT

Jacuzzi	For 6 x People, on the sun deck
---------	---------------------------------

# BARON TRENCK



## TENDERS & TOYS

Tenders:	1 Naumatec Mod. TL 650 - VOLVO Aquamatic D3-220 DPS 44 Knots 1 Zodiac Yachtline de Luxe 380 – Motore YAMAHA 40 CV FB
Toys:	Aquaglide Park with: Trampoline Soaker / lounge Runway Slide Blast Water skis Wakeboard 2x 2-person inflatable kayaks 2 Inflatable Paddle board Towable toys 1 sea bob F7 Snorkelling sets

## OTHER EQUIPMENT (PLEASE ADD REFIT WORKS DONE 2021/2022)

### 2021/2022

W6 Main engine  
Revision G.E.  
Revision Bow Thruster  
Review of weathermakers  
Review Compressor Refrigerator  
Revision Fresh Water Pressure  
New Evac pump  
Revision water softener  
Revision, cleaning, and disinfection Air Condition  
Revision black water pump  
Revision, wash, and flushing Sprinkler  
Revision Frequency Converter  
Hull painting (Winter 2022/2023)  
Teak deck refurbishment (Winter 2022/2023)





# M/Y BARON TRENCK

43.50 m, 478 GT

